

SSK TOOLING SYSTEM

# SHELL MILL ARBOR

- AUFNAHMEDORN FÜR FRÄSER MIT BOHRUNG
- MANDRIN PORTE-FRAISES
- MANDRINO CON TRASCINAMENTO FISSO
- PORTA FRESAS



## SHELL MILL ARBOR

DIN 69871-SK

DIN 69893/ISO 12164-1-HSK

CBT (BT DUAL CONTACT)

JIS B6339/MAS 403-BT

GOST 25827-93

## COMBI SHELL MILL ARBOR

DIN 69871-SK

DIN 69893/ISO 12164-1-HSK

CBT (BT DUAL CONTACT)

JIS B6339/MAS 403-BT

DIN 2080-ISO

**SSK**

## SHELL MILL ARBOR

AUFNAHMEDORN FÜR FRÄSER MIT BOHRUNG  
MANDRIN PORTE-FRAISES  
MANDRINO CON TRASCINAMENTO FISSO  
PORTA FRESAS

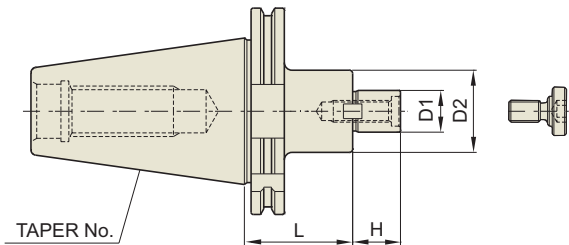
DIN 69871  
-SKTaper  
Accuracy  
AT3G Value  
6.3RPM  
15,000Coolant  
System  
A

## ■ DIN 69871-SK

## ◆ STANDARD

Unit : mm

TAPER No.	MODEL No.	D1	D2	L	H	WEIGHT (Kg)
30	SK30-SMA16-50	16	32	50	17	0.85
	SK30-SMA22-50	22	40	50	19	0.90
	SK30-SMA27-50	27	48	50	21	1.03
40	SK40-SMA16-60	16	32	60	17	0.35
	SK40-SMA22-60	22	40	60	19	1.45
	SK40-SMA27-60	27	48	60	21	1.70
	SK40-SMA32-60	32	58	60	24	1.80
	SK40-SMA40-60	40	70	60	27	3.10
50	SK50-SMA16-75	16	32	75	17	2.80
	SK50-SMA22-75	22	40	75	19	3.10
	SK50-SMA27-75	27	48	75	21	3.40
	SK50-SMA32-75	32	58	75	24	3.80
	SK50-SMA40-75	40	70	75	27	4.50
	SK50-SMA50-75	50	90	75	30	5.90

## ◆ EXTENDED

Unit : mm

TAPER No.	MODEL No.	D1	D2	L	H	WEIGHT (Kg)
40	SK40-SMA16-120	16	32	120	17	1.70
	SK40-SMA22-120	22	40	120	19	1.80
	SK40-SMA27-120	27	48	120	21	2.40
	SK40-SMA32-120	32	58	120	24	3.70
50	SK50-SMA16-120	16	32	120	17	3.90
	SK50-SMA22-120	22	40	120	19	4.40
	SK50-SMA27-120	27	48	120	21	4.70
	SK50-SMA32-120	32	58	120	24	5.00
	SK50-SMA40-120	40	70	120	27	6.05

- ▶ Through coolant system is optional.
- ▶ CAT(ANSI B5.50) taper and Inch type products are available.
- ▶ For parts, please refer to page 131.

# SHELL MILL ARBOR

SSK **POP**

**SMA**

AUFNAHMEDORN FÜR FRÄSER MIT BOHRUNG  
 MANDRIN PORTE-FRAISES  
 MANDRINO CON TRASCINAMENTO FISSO  
 PORTA FRESAS

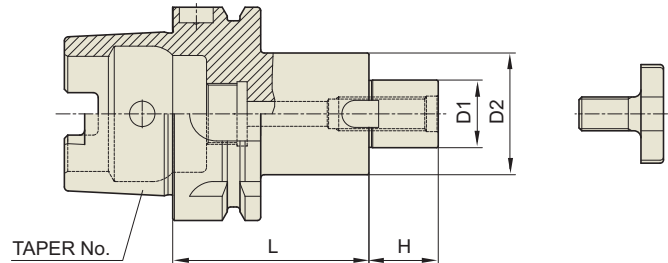

## ■ DIN 69893/ISO 12164-1-HSK FORM A

DIN 69893 - HSK	Taper Accuracy -	G Value 6.3	RPM 15,000	Coolant System A
-----------------	---------------------	----------------	---------------	---------------------

Unit : mm

TAPER No.	MODEL No.	D1	D2	L	H	WEIGHT (Kg)
40A	HSK40A-SMA16-50	16	32	50	17	0.40
	HSK40A-SMA22-50	22	40	50	19	0.50
	HSK40A-SMA27-60	27	48	60	21	0.60
50A	HSK50A-SMA16-50	16	32	50	17	0.50
	HSK50A-SMA22-60	22	40	60	19	0.57
	HSK50A-SMA27-60	27	48	60	21	0.75
	HSK50A-SMA32-60	32	58	60	24	0.90
63A	HSK63A-SMA16-50	16	32	50	17	0.81
	HSK63A-SMA22-50	22	40	50	19	0.93
	HSK63A-SMA27-60	27	48	60	21	1.22
	HSK63A-SMA32-60	32	58	60	24	1.46
	HSK63A-SMA40-60	40	70	60	27	1.80
100A	HSK100A-SMA16-50	16	32	50	17	2.14
	HSK100A-SMA22-50	22	40	50	19	2.25
	HSK100A-SMA27-50	27	48	50	21	2.40
	HSK100A-SMA32-50	32	58	50	24	2.60
	HSK100A-SMA40-60	40	70	60	27	3.25
	HSK100A-SMA50-70	50	90	70	30	5.40

- ▶ Through coolant system is optional.
- ▶ For parts, please refer to page 131.

# SHELL MILL ARBOR

SSK Supreme

SMA

AUFNAHMEDORN FÜR FRÄSER MIT BOHRUNG  
 MANDRIN PORTE-FRAISES  
 MANDRINO CON TRASCINAMENTO FISSO  
 PORTA FRESAS

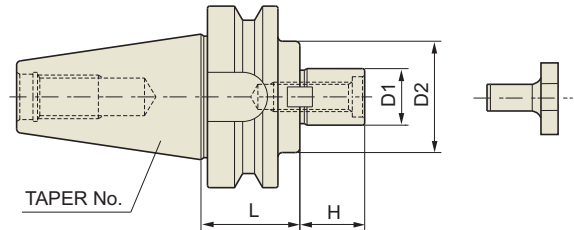

CBT	Taper Accuracy AT3	G Value 2.5	RPM 25,000	Coolant System A
-----	-----------------------	----------------	---------------	---------------------

## ■ CBT (BT DUAL CONTACT)

### ◆ STANDARD

Unit : mm

TAPER No.	MODEL No.	D1	D2	L	H	WEIGHT (Kg)
30	CBT30-SMA16-50	16	32	30	17	
	CBT30-SMA22-50	22	40	30	19	
	CBT30-SMA27-50	27	48	30	21	
40	CBT40-SMA16-60	16	32	60	17	
	CBT40-SMA22-60	22	40	60	19	
	CBT40-SMA27-60	27	48	60	21	
	CBT40-SMA32-60	32	58	60	24	
	CBT40-SMA40-60	40	70	60	27	
50	CBT50-SMA16-75	16	32	75	17	
	CBT50-SMA22-75	22	40	75	19	
	CBT50-SMA27-75	27	48	75	21	
	CBT50-SMA32-75	32	58	75	24	
	CBT50-SMA40-75	40	70	75	27	
	CBT50-SMA50-75	50	90	75	30	

### ◆ EXTENDED

Unit : mm

TAPER No.	MODEL No.	D1	D2	L	H	WEIGHT (Kg)
40	CBT40-SMA16-120	16	32	120	17	
	CBT40-SMA22-120	22	40	120	19	
	CBT40-SMA27-120	27	48	120	21	
	CBT40-SMA32-120	32	58	120	24	
50	CBT50-SMA16-120	16	32	120	17	
	CBT50-SMA22-120	22	40	120	19	
	CBT50-SMA27-120	27	48	120	21	
	CBT50-SMA32-120	32	58	120	24	
	CBT50-SMA40-120	40	70	120	27	

- ▶ Through coolant system is optional.
- ▶ For parts, please refer to page 131.

# SHELL MILL ARBOR

SSK **POP**

**SMA**

AUFNAHMEDORN FÜR FRÄSER MIT BOHRUNG  
MANDRIN PORTE-FRAISES  
MANDRINO CON TRASCINAMENTO FISSO  
PORTA FRESAS

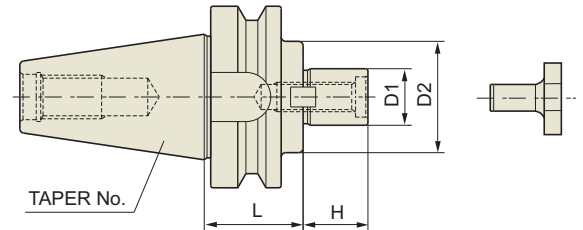

## ■ JIS B6339/MAS 403-BT

JIS B6339 -BT	Taper Accuracy AT3	G Value 6.3	RPM 15,000	Coolant System A
------------------	--------------------------	----------------	---------------	------------------------

### ◆ STANDARD

Unit : mm

TAPER No.	MODEL No.	D1	D2	L	H	WEIGHT (Kg)
30	BT30-SMA16-50	16	32	30	17	
	BT30-SMA22-50	22	40	30	19	
	BT30-SMA27-50	27	48	30	21	
40	BT40-SMA16-60	16	32	60	17	
	BT40-SMA22-60	22	40	60	19	
	BT40-SMA27-60	27	48	60	21	
	BT40-SMA32-60	32	58	60	24	
	BT40-SMA40-60	40	70	60	27	
50	BT50-SMA16-75	16	32	75	17	
	BT50-SMA22-75	22	40	75	19	
	BT50-SMA27-75	27	48	75	21	
	BT50-SMA32-75	32	58	75	24	
	BT50-SMA40-75	40	70	75	27	
	BT50-SMA50-75	50	90	75	30	

### ◆ EXTENDED

Unit : mm

TAPER No.	MODEL No.	D1	D2	L	H	WEIGHT (Kg)
40	BT40-SMA16-120	16	32	120	17	
	BT40-SMA22-120	22	40	120	19	
	BT40-SMA27-120	27	48	120	21	
	BT40-SMA32-120	32	58	120	24	
50	BT50-SMA16-120	16	32	120	17	
	BT50-SMA22-120	22	40	120	19	
	BT50-SMA27-120	27	48	120	21	
	BT50-SMA32-120	32	58	120	24	
	BT50-SMA40-120	40	70	120	27	

- ▶ Through coolant system is optional.
- ▶ CAT(ANSI B5.50) taper and Inch type products are available.
- ▶ For parts, please refer to page 131.

## SHELL MILL ARBOR

AUFNAHMEDORN FÜR FRÄSER MIT BOHRUNG  
 MANDRIN PORTE-FRAISES  
 MANDRINO CON TRASCINAMENTO FISSO  
 PORTA FRESAS

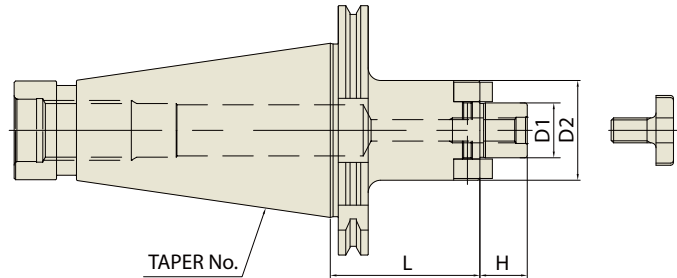

GOST 25827-93	Taper Accuracy AT3	G Value -	RPM -	Coolant System A
------------------	--------------------------	--------------	----------	------------------------

## ■ GOST 25827-93

Unit : mm

TAPER No.	MODEL No.	D1	D2	L	H	WEIGHT (Kg)
40	GOST40-SMA16-40	16	32	40	17	
	GOST40-SMA16-100	16	32	100	17	
	GOST40-SMA22-40	22	40	40	19	
	GOST40-SMA22-100	22	40	100	19	
	GOST40-SMA27-45	27	48	45	21	
	GOST40-SMA32-45	32	58	45	24	
50	GOST50-SMA16-40	16	32	40	17	
	GOST50-SMA16-100	16	32	100	17	
	GOST40-SMA22-40	22	40	40	19	
	GOST40-SMA22-100	22	40	100	19	
	GOST40-SMA27-45	27	48	45	21	
	GOST40-SMA27-120	27	48	120	21	
	GOST40-SMA32-45	32	58	45	24	
	GOST40-SMA32-130	32	58	130	24	
	GOST40-SMA40-55	40	70	55	27	
	GOST40-SMA40-150	40	70	150	27	
GOST40-SMA50-60	50	90	60	30		

► For parts, please refer to page 131.

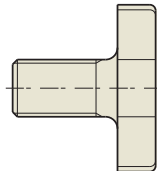

## ■ COLLAR BOLT

No.	COLLAR BOLT	Q'TY	SMA Dia.
33	M8×1.25	1	16
34	M10×1.5	1	22
35	M12×1.75	1	27
36	M16×2.0	1	32
37	M20×2.5	1	40
38	M24×3.0	1	50

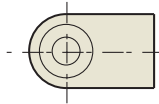

## ■ DRIVE KEY

No.	DRIVE KEY	Q'TY	SMA Dia.
45	8×7×2.8	2	16
46	10×7.8×15.5	2	22
47	12×9×18.5	2	27
48	14×11.5×20.5	2	32
49	16×13.5×23.5	2	40
50	18×18×28.5	2	50

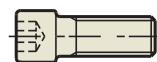

## ■ KEY BOLT

No.	KEY BOLT	Q'TY	SMA Dia.
51	M3×0.5×8L	2	16
52	M4×0.7×10L	2	22
53	M5×0.8×12L	2	27
54	M6×1.0×15L	2	32
55	M6×1.0×15L	2	40
56	M6×1.0×20L	2	50

# COMBI-SHELL MILL ARBOR

KOMBI-AUFNAHMEDORN FÜR FRÄSER MIT BOHRUNG  
 MANDRIN PORTE-FRAISES COMBINÉS  
 MANDRINO PORTA FRESE  
 PORTA FRESAS COMBINADO

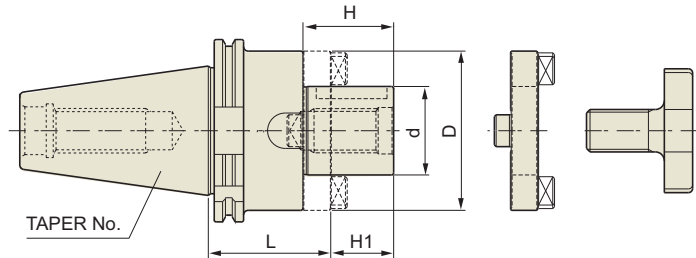
DIN 69871  
-SKTaper  
Accuracy  
AT3G Value  
6.3RPM  
15,000Coolant  
System  
A

## ■ DIN 69871-SK

### ◆ STANDARD

Unit : mm

TAPER No.	MODEL No.	d	L	D	H1	H	PART No.	WEIGHT (Kg)
30	SK30-CMA16-50	16	50	32	17	27	27, 33, 39	
	SK30-CMA22-50	22	50	40	19	31	28, 34, 40	
	SK30-CMA27-55	27	55	48	21	33	29, 35, 41	
40	SK40-CMA16-55	16	55	32	17	27	27, 33, 39	
	SK40-CMA22-55	22	55	40	19	31	28, 34, 40	
	SK40-CMA27-55	27	55	48	21	33	29, 35, 41	
	SK40-CMA32-60	32	60	58	24	38	30, 36, 42	
	SK40-CMA40-60	40	60	70	27	41	31, 37, 43	
50	SK50-CMA16-55	16	55	32	17	27	27, 33, 39	
	SK50-CMA22-55	22	55	40	19	31	28, 34, 40	
	SK50-CMA27-55	27	55	48	21	33	29, 35, 41	
	SK50-CMA32-55	32	55	58	24	38	30, 36, 42	
	SK50-CMA40-55	40	55	70	27	41	31, 37, 43	
	SK50-CMA50-70	50	70	90	30	46	32, 38, 44	

### ◆ EXTENDED

Unit : mm

TAPER No.	MODEL No.	d	L	D	H1	H	PART No.	WEIGHT (Kg)
40	SK40-CMA16-100	16	100	32	17	27	27, 33, 39	
	SK40-CMA22-100	22	100	40	19	31	28, 34, 40	
	SK40-CMA27-100	27	100	48	21	33	29, 35, 41	
	SK40-CMA32-100	32	100	58	24	38	30, 36, 42	
50	SK50-CMA16-100	16	100	32	17	27	27, 33, 39	
	SK50-CMA22-100	22	100	40	19	31	28, 34, 40	
	SK50-CMA27-100	27	100	48	21	33	29, 35, 41	
	SK50-CMA32-100	32	100	58	24	38	30, 36, 42	
	SK50-CMA40-100	40	100	70	27	41	31, 37, 43	

▶ CAT(ANSI B5.50) taper and Inch type products are available.

▶ For parts, please refer to page 137.



# COMBI-SHELL MILL ARBOR

SSK **POP**

**CMA**

KOMBI-AUFNAHMEDORN FÜR FRÄSER MIT BOHRUNG  
 MANDRIN PORTE-FRAISES COMBINÉS  
 MANDRINO PORTA FRESE  
 PORTA FRESAS COMBINADO

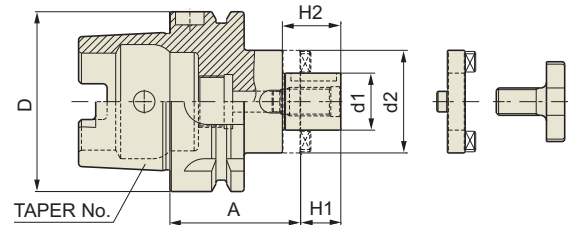

## ■ DIN 69893/ISO 12164-1-HSK FORM A

<b>DIN 69893 - HSK</b>	<b>Taper Accuracy</b> -	<b>G Value</b> 6.3	<b>RPM</b> 15,000	<b>Coolant System</b> A
------------------------	----------------------------	-----------------------	----------------------	----------------------------

Unit : mm

TAPER No.	MODEL No.	D	d1	d2	A	H1	H2	PART No.	WEIGHT (Kg)
50A	HSK50A-CMA16-50	50	16	32	50	17	27	27, 33, 39	
	HSK50A-CMA22-50	50	22	40	50	19	31	28, 34, 40	
	HSK50A-CMA27-65	50	27	48	65	21	33	29, 35, 41	
	HSK50A-CMA32-65	50	32	58	65	24	38	30, 36, 42	
63A	HSK63A-CMA16-60	63	16	32	60	17	27	27, 33, 39	
	HSK63A-CMA22-60	63	22	40	60	19	31	28, 34, 40	
	HSK63A-CMA27-60	63	27	48	60	21	33	29, 35, 41	
	HSK63A-CMA32-60	63	32	53	60	24	38	30, 36, 42	
	HSK63A-CMA40-70	63	40	70	70	27	41	31, 37, 43	
100A	HSK100A-CMA16-60	100	16	32	60	17	27	27, 33, 39	
	HSK100A-CMA22-60	100	22	40	60	19	31	28, 34, 40	
	HSK100A-CMA27-60	100	27	48	60	21	33	29, 35, 41	
	HSK100A-CMA32-60	100	32	58	60	24	38	30, 36, 42	
	HSK100A-CMA40-70	100	40	70	70	27	41	31, 37, 43	
	HSK100A-CMA50-80	100	50	90	80	30	46	32, 38, 44	

► For parts, please refer to page 137.

# COMBI-SHELL MILL ARBOR

SSK Supreme

CMA

KOMBI-AUFNAHMEDORN FÜR FRÄSER MIT BOHRUNG  
 MANDRIN PORTE-FRAISES COMBINÉS  
 MANDRINO PORTA FRESE  
 PORTA FRESAS COMBINADO

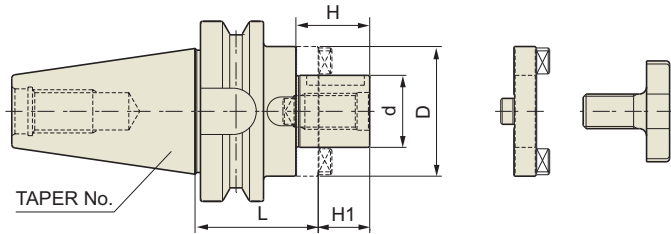

CBT	Taper Accuracy AT3	G Value 2.5	RPM 25,000	Coolant System A
-----	-----------------------	----------------	---------------	---------------------

## ■ CBT (BT DUAL CONTACT)

### ◆ STANDARD

Unit : mm

TAPER No.	MODEL No.	d	L	D	H1	H	PART No.	WEIGHT (Kg)
30	CBT30-CMA16-50	16	50	32	17	27	27, 33, 39	
	CBT30-CMA22-50	22	50	40	19	31	28, 34, 40	
	CBT30-CMA27-55	27	55	48	21	33	29, 35, 41	
40	CBT40-CMA16-55	16	55	32	17	27	27, 33, 39	
	CBT40-CMA22-55	22	55	40	19	31	28, 34, 40	
	CBT40-CMA27-55	27	55	48	21	33	29, 35, 41	
	CBT40-CMA32-60	32	60	58	24	38	30, 36, 42	
	CBT40-CMA40-70	40	70	70	27	41	31, 37, 43	
50	CBT50-CMA16-70	16	70	32	17	27	27, 33, 39	
	CBT50-CMA22-70	22	70	40	19	31	28, 34, 40	
	CBT50-CMA27-70	27	70	48	21	33	29, 35, 41	
	CBT50-CMA32-70	32	70	58	24	38	30, 36, 42	
	CBT50-CMA40-70	40	70	70	27	41	31, 37, 43	
	CBT50-CMA50-70	50	70	90	30	46	32, 38, 44	

### ◆ EXTENDED

Unit : mm

TAPER No.	MODEL No.	d	L	D	H1	H	PART No.	WEIGHT (Kg)
40	CBT40-CMA16-100	16	100	32	17	27	27, 33, 39	
	CBT40-CMA22-100	22	100	40	19	31	28, 34, 40	
	CBT40-CMA27-100	27	100	48	21	33	29, 35, 41	
	CBT40-CMA32-100	32	100	58	24	38	30, 36, 42	
50	CBT50-CMA16-100	16	100	32	17	27	27, 33, 39	
	CBT50-CMA22-100	22	100	40	19	31	28, 34, 40	
	CBT50-CMA27-100	27	100	48	21	33	29, 35, 41	
	CBT50-CMA32-100	32	100	58	24	38	30, 36, 42	
	CBT50-CMA40-100	40	100	70	27	41	31, 37, 43	

► For parts, please refer to page 137.

# COMBI-SHELL MILL ARBOR

SSK POP

CMA

KOMBI-AUFNAHMEDORN FÜR FRÄSER MIT BOHRUNG  
 MANDRIN PORTE-FRAISES COMBINÉS  
 MANDRINO PORTA FRESE  
 PORTA FRESAS COMBINADO

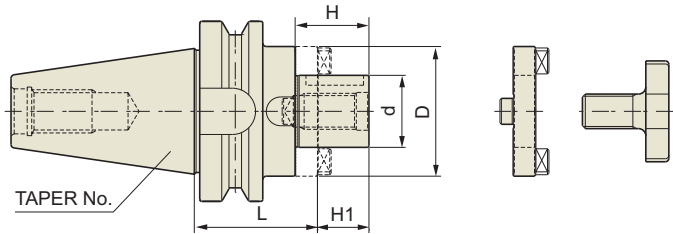

## ■ JIS B6339/MAS 403-BT

JIS B6339 -BT	Taper Accuracy AT3	G Value 6.3	RPM 15,000	Coolant System A
------------------	--------------------------	----------------	---------------	------------------------

### ◆ STANDARD

Unit : mm

TAPER No.	MODEL No.	d	L	D	H1	H	PART No.	WEIGHT (Kg)
30	BT30-CMA16-50	16	50	32	17	27	27, 33, 39	
	BT30-CMA22-50	22	50	40	19	31	28, 34, 40	
	BT30-CMA27-55	27	55	48	21	33	29, 35, 41	
40	BT40-CMA16-55	16	55	32	17	27	27, 33, 39	
	BT40-CMA22-55	22	55	40	19	31	28, 34, 40	
	BT40-CMA27-55	27	55	48	21	33	29, 35, 41	
	BT40-CMA32-60	32	60	58	24	38	30, 36, 42	
	BT40-CMA40-70	40	70	70	27	41	31, 37, 43	
50	BT50-CMA16-70	16	70	32	17	27	27, 33, 39	
	BT50-CMA22-70	22	70	40	19	31	28, 34, 40	
	BT50-CMA27-70	27	70	48	21	33	29, 35, 41	
	BT50-CMA32-70	32	70	58	24	38	30, 36, 42	
	BT50-CMA40-70	40	70	70	27	41	31, 37, 43	
	BT50-CMA50-70	50	70	90	30	46	32, 38, 44	

### ◆ EXTENDED

Unit : mm

TAPER No.	MODEL No.	d	L	D	H1	H	PART No.	WEIGHT (Kg)
40	BT40-CMA16-100	16	100	32	17	27	27, 33, 39	
	BT40-CMA22-100	22	100	40	19	31	28, 34, 40	
	BT40-CMA27-100	27	100	48	21	33	29, 35, 41	
	BT40-CMA32-100	32	100	58	24	38	30, 36, 42	
50	BT50-CMA16-100	16	100	32	17	27	27, 33, 39	
	BT50-CMA22-100	22	100	40	19	31	28, 34, 40	
	BT50-CMA27-100	27	100	48	21	33	29, 35, 41	
	BT50-CMA32-100	32	100	58	24	38	30, 36, 42	
	BT50-CMA40-100	40	100	70	27	41	31, 37, 43	

- ▶ CAT(ANSI B5.50) taper and Inch type products are available.
- ▶ For parts, please refer to page 137.

Hydraulic Chuck  
 Shrink Fit Holder  
 ER Collet Chuck  
 End Mill Holder & Side Lock Arbor  
 Shell Mill Arbor  
 Power Milling Chuck  
 Morse Taper Arbor  
 SK Slim Chuck  
 Synchro Tapping Chuck  
 Tapping ER Chuck  
 Tapping Chuck  
 Face Mill Arbor  
 NC Drill Chuck & Other Tool Holders  
 Boring System  
 Accessory & Others

# COMBI-SHELL MILL ARBOR

KOMBI-AUFNAHMEDORN FÜR FRÄSER MIT BOHRUNG  
 MANDRIN PORTE-FRAISES COMBINÉS  
 MANDRINO PORTA FRESE  
 PORTA FRESAS COMBINADO

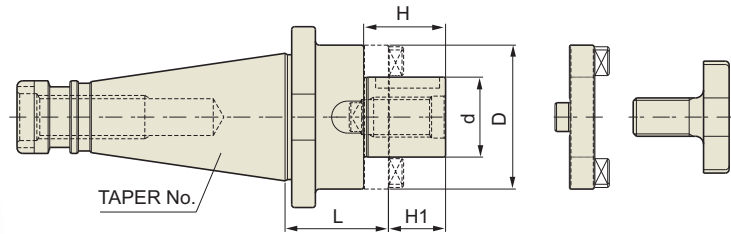
DIN 2080  
- ISOTaper  
Accuracy  
AT3

G Value

-

RPM

-

Coolant  
System  
A

## ■ DIN 2080-ISO

### ◆ STANDARD

Unit : mm

TAPER No.	MODEL No.	d	L	D	H1	H	PART No.	WEIGHT (Kg)
30	ISO30-CMA16-35	16	35	32	17	27	27, 33, 39	
	ISO30-CMA22-35	22	35	40	19	31	28, 34, 40	
	ISO30-CMA27-35	27	35	48	21	33	29, 35, 41	
40	ISO40-CMA16-52	16	52	32	17	27	27, 33, 39	
	ISO40-CMA22-52	22	52	40	19	31	28, 34, 40	
	ISO40-CMA27-52	27	52	48	21	33	29, 35, 41	
	ISO40-CMA32-52	32	52	58	24	38	30, 36, 42	
50	ISO40-CMA40-52	40	52	70	27	41	31, 37, 43	
	ISO50-CMA16-55	16	55	32	17	27	27, 33, 39	
	ISO50-CMA22-55	22	55	40	19	31	28, 34, 40	
	ISO50-CMA27-55	27	55	48	21	33	29, 35, 41	
	ISO50-CMA32-55	32	55	58	24	38	30, 36, 42	
	ISO50-CMA40-55	40	55	70	27	41	31, 37, 43	
	ISO50-CMA50-55	50	55	90	30	46	32, 38, 44	

### ◆ EXTENDED

Unit : mm

TAPER No.	MODEL No.	d	L	D	H1	H	PART No.	WEIGHT (Kg)
40	ISO40-CMA16-125	16	125	32	17	27	27, 33, 39	
	ISO40-CMA22-125	22	125	40	19	31	28, 34, 40	
	ISO40-CMA27-125	27	125	48	21	33	29, 35, 41	
	ISO40-CMA32-125	32	125	58	24	38	30, 36, 42	
50	ISO50-CMA16-125	16	125	32	17	27	27, 33, 39	
	ISO50-CMA22-125	22	125	40	19	31	28, 34, 40	
	ISO50-CMA27-125	27	125	48	21	33	29, 35, 41	
	ISO50-CMA32-125	32	125	58	24	38	30, 36, 42	
	ISO50-CMA40-125	40	125	70	27	41	31, 37, 43	

▶ CAT(ANSI B5.50) taper and Inch type products are available.

▶ For parts, please refer to page 137.

# DRIVE RING, BOLT & KEY (For COMBI-SHELL MILL ARBOR)

## PART

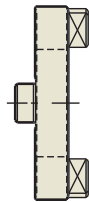

### ■ CLUTCH DRIVE RING

No.	CLUTCH DRIVE RING	Q'TY	CMA Dia.
27	#16	1	16
28	#22	1	22
29	#27	1	27
30	#32	1	32
31	#40	1	40
32	#50	1	50

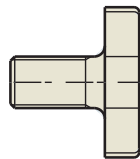

### ■ COLLAR BOLT

No.	COLLAR BOLT	Q'TY	CMA Dia.
33	M8×1.25	1	16
34	M10×1.5	1	22
35	M12×1.75	1	27
36	M16×2.0	1	32
37	M20×2.5	1	40
38	M24×3.0	1	50

### ■ KEY

No.	KEY	Q'TY	CMA Dia.
39	4×4×20	1	16
40	6×6×25	1	22
41	7×7×25	1	27
42	8×7×28	1	32
43	10×8×32	1	40
44	12×8×36	1	50

